

237 Fairmile Road
Christchurch
Dorset
BH23 2LQ

01202 487587

MICHAEL ADAM

post@michaeladam.co.uk

www.michaeladam.co.uk



These particulars are intended to give a fair description of the property, but their accuracy is not guaranteed and they do not constitute an offer or contract.

DRAFT DETAILS – AWAITING VERIFICATION FROM VENDOR

**50 CORHAMPTON ROAD
BOSCOMBE EAST, BOURNEMOUTH
BH6 5PB**

Price £679,950

Freehold



THIS IS AN EXCEPTIONALLY SPACIOUS AND EXTREMELY WELL PRESENTED FAMILY HOME SITUATED WITHIN A VERY POPULAR LOCATION BEING WITHIN CLOSE PROXIMITY TO SOUTHBORNE GROVE AND BEAUTIFUL LOCAL BEACHES.

THIS FAMILY HOME HAS BEEN EXTENDED CREATING VERSATILE LIVING SPACE WHICH INCLUDES ENTRANCE HALL, GROUND FLOOR CLOAKS, SITTING ROOM WITH FEATURE FIREPLACE, SEPARATE 23FT LONG FAMILY/DINING ROOM, 20FT LONG KITCHEN, CONSERVATORY, SPACIOUS LANDING, 4 WELL PROPORTIONED DOUBLE BEDROOMS WITH THE MASTER BEDROOMS HAVING AN EN-SUITE SHOWER ROOM AND A FURTHER LUXURIOUS FAMILY BATHROOM. ACCESS FROM THE LANDING VIA A LADDER LEADS UP TO THE SECOND FLOOR LOFT ROOMS WHICH COULD BE USED AS OFFICE SPACE OR TEENAGERS DEN.

EXTERNALLY THERE IS OFF ROAD PARKING, GARAGE AND A GOOD SIZED REAR GARDEN WHICH OFFERS AN EXCELLENT DEGREE OF PRIVACY.

WE STRONGLY ADVISE AN EARLY INTERNAL INSPECTION TO FULLY APPRECIATE THE SIAE OF ACCOMMODATION ON OFFER.

50 CORHAMPTON ROAD, BOSCOMBE EAST, BOURNEMOUTH BH6 5PB

- **EXTENDED FAMILY HOME**
- **EXTREMELY SPACIOUS ACCOMMODATION**
- **DOUBLE GLAZING**
- **GAS FIRED CENTRAL HEATING**
- **4 GOOD SIZE BEDROOMS**
- **CHARACTER SITTING ROOM**
- **23FT FAMILY/DINING ROOM**
- **20FT KITCHEN**
- **CONSERVATORY**
- **LUXURIOUS FAMILY BATHROOM**
- **OFF ROAD PARKING AND GARAGE**
- **WELL PROPORTIONED GARDENS**
- **POPULAR LOCATION**
- **GROUND FLOOR CLOAKROOM**
- **VEIWING ADVISED**



VIEWING STRICTLY BY APPOINTMENT PLEASE

Please note that the equipment, fittings, fireplaces, heating systems, mains services, apparatus and appliances have not been tested by us the agents so we cannot confirm that they are in working order. All measurements are approximate and are for guidance only.



50 CORHAMPTON ROAD, BOSCOMBE EAST, BOURNEMOUTH BH6 5PB

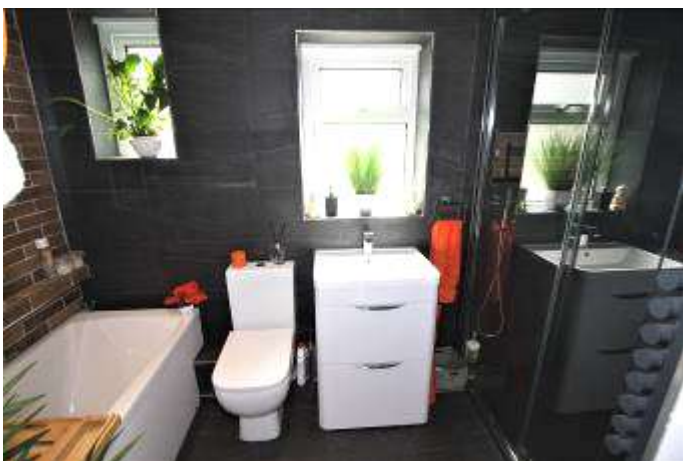

50 CORHAMPTON ROAD, BOSCOMBE EAST, BOURNEMOUTH BH6 5PB



50 CORHAMPTON ROAD, BOSCOMBE EAST, BOURNEMOUTH BH6 5PB

Ground Floor

Approx. 75.5 sq. metres (812.8 sq. feet)

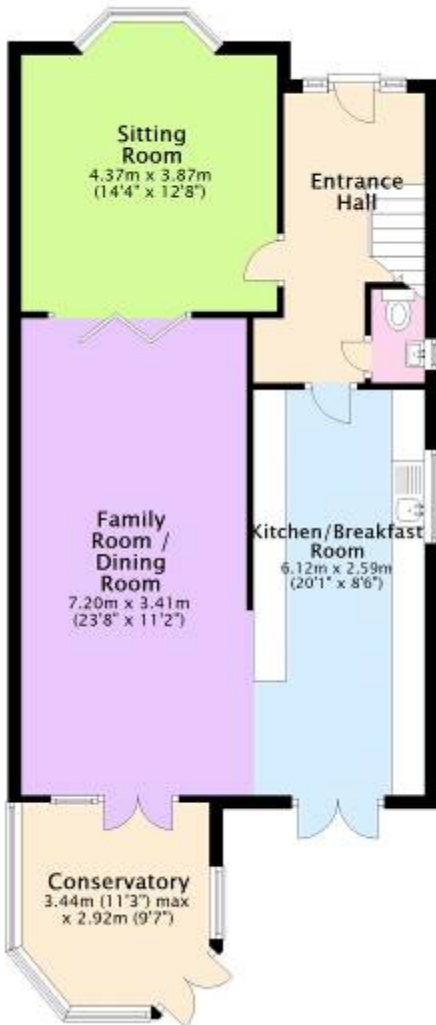

First Floor

Approx. 68.6 sq. metres (738.2 sq. feet)



Second Floor

Approx. 23.7 sq. metres (254.9 sq. feet)

