

237 Fairmile Road
Christchurch
Dorset
BH23 2LQ

01202 487587

MICHAEL ADAM

post@michaeladam.co.uk

www.michaeladam.co.uk



These particulars are intended to give a fair description of the property, but their accuracy is not guaranteed and they do not constitute an offer or contract.

DRAFT DETAILS – AWAITING VERIFICATION FROM VENDOR

**27 BEACONSFIELD ROAD
CHRISTCHURCH
BH23 1QT**

OIEO Price £300,000

Freehold



SITUATED WITHIN A SHORT STROLL TO CHRISTCHURCH TOWN CENTRE AND HIGH STREET IS THIS MID TERRACE CHARACTER COTTAGE.

THE PROPERTY CONSISTS OF ENTRANCE HALL, LOUNGE/DINER, KITCHEN, 2 BEDROOMS AND SHOWER ROOM.

THE PROPERTY IS NOW IN NEED OF SOME GENERAL UPDATING BUT DOES HAVE A RECENTLY REPLACED BOILER FOR THE GAS CENTRAL HEATING AND DOUBLE GLAZING. IT IS IDEAL FOR THOSE LOOKING FOR A D.I.Y PROJECT ENABLING THEM TO CREATE A COMFORTABLE HOME. A FURTHER BENEFIT CONVEYED WITH THE PROPERTY IS A GOOD SIZE, WELL STOCKED REAR GARDEN WHICH OFFERS AN EXCELLENT DEGREE OF PRIVACY AND SECLUSION AND THE ADDED BENEFIT OF BEING OFFERED FOR SALE WITH NO FORWARD CHAIN. IDEALLY LOCATED FOR THE HIGH STREET SHOPS AND AMENITIES ALONG BARGATES AND ALSO BEING WITHIN EASY REACH OF CHRISTCHURCH MAIN LINE RAILWAY STATION.

27 BEACONSFIELD ROAD, CHRISTCHURCH BH23 1QT

- **MID TERRACE COTTAGE**
- **2 BEDROOMS**
- **RECENTLY REPLACED BOILER FOR CENTRAL HEATING**
- **DOUBLE GLAZING**
- **ATTRACTIVE AND PRIVATE REAR GARDEN**
- **NO FORWARD CHAIN**
- **MODERN STYLE KITCHEN AND SHOWER ROOM**
- **GOOD SIZE LOUNGE/DINER**
- **CLOSE TO HIGH STREET**
- **WALKING DISTANCE TO RAILWAY STATION**
- **IDEAL DIY PROJECT**
- **PERFECT FIRST TIME BUY OR INVESTMENT**

VIEWING STRICTLY BY APPOINTMENT PLEASE

Please note that the equipment, fittings, fireplaces, heating systems, mains services, apparatus and appliances have not been tested by us the agents so we cannot confirm that they are in working order. All measurements are approximate and are for guidance only.



27 BEACONSFIELD ROAD, CHRISTCHURCH BH23 1QT



27 BEACONSFIELD ROAD, CHRISTCHURCH BH23 1QT



Ground Floor

Approx. 32.9 sq. metres (354.2 sq. feet)

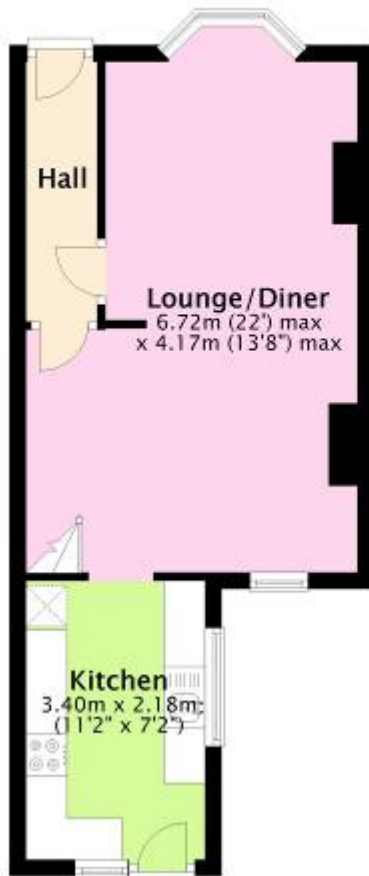

First Floor

Approx. 25.1 sq. metres (270.4 sq. feet)



27 BEACONSFIELD ROAD, CHRISTCHURCH BH23 1QT